

1.a. Property Name, Historic		14. MDAH Inventory Code 142
1.b. Property Name, Common		15. County Lafayette
2. Property Address 1510 Jackson Avenue		16. City Oxford
3. Legal Description 86R:161		20. USGS Quad Map
19. Ownership private	22. Condition fair	21. UTM Reference
4. Former/Historic Uses residence	5. Present Use residence	24. Principal Materials wood frame
6 & 7. Significant persons, events, themes, including dates of association		
8. Date of Construction ca. 1925	9. Historic Changes	23. Post Historic Changes siding, ca. 1990
10. Architect	11. Builder/Contractor	25. Architectural Style Craftsman

13. Outbuildings or Secondary Features (use sep. form if important)

12. Brief Description: One-story, three-bay, frame bungalow with Craftsman influence, built ca. 1925. Gable roof covered with asphalt shingles, with box cornice. Exterior walls covered with vinyl siding. Windows are 6/6 double-hung sashes, some in pairs. Partial-width, undercut porch supported by replacement box piers. Entrance contains a Craftsman single-light, three-panel door.

30. Historical Information: This structure first appears in the 1948 Sanborn map series.

31. Historical Contexts:

33. Sources of Information:

MISSISSIPPI HISTORIC RESOURCES INVENTORY

Page 2

32. Additional Remarks or Information:

35. Owner's Name and Address

36. Photographer/Source
John Hopkins

37. Photo Roll/Frame
3559:32

38. Photo Date
January, 2000

39. Form by Hopkins & Associates, Memphis, TN

40. Survey Project Oxford

Date of Form January, 2000

Attach Photograph



MDAH INFORMATION

26. Category

27. Functional Type

28. Registration Status/Dates
 NHL
 Listed NR
 In NR District
 Federal DOE
 State Landmark
 Local Landmark
 In Local District
 HABS/HAER

29. District Name

Rating C/N C
 Inventory #

42. Other HPD Information

43. Evaluation

a. Already Listed NR
 Individually Eligible
 Eligible if Restored
 Contribute to District
 Apparently Not Eligible
 Insufficient Information
 Not Extant

b. Area(s) of Significance

c. Evaluated by/date

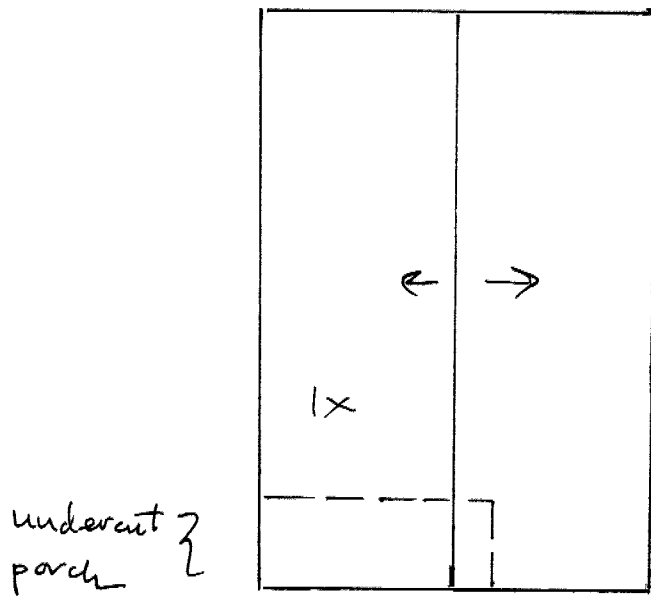

undercut porch }



1510 Jackson

↙ N